



Ash Lane
Down Hatherley
Gloucester
GL2 9PS

Offers In Excess Of £790,000

bettermove 

Ash Lane Gloucester

Bettermove are proud to present this 6 bedroom detached house in Gloucester.

As you can see by the images, the works are not complete and will need to be finished by the new owner.

The property benefits from double glazing, LPG central heating throughout and has off street parking available via the driveway and detached garage.

The council tax band is E.

The interior of this beautifully presented property comprises a spacious living room, 2 bedrooms, shower room and fitted kitchen diner on the ground floor. The first floor consists of 4 bedrooms, 3 en-suite shower rooms and 1 en-suite bathroom. The exterior boasts a private rear garden, perfect for enjoying the summer months.

Located in the popular village of Down Hatherley, the property is close to a range of amenities, including shops, supermarkets, restaurants and pubs. Excellent transport connections can be found from the A38, A40 and M5.

This exciting opportunity should not be missed! All enquiries can be made through Bettermove on 0330 004 0050.



Sunnylea, Ash Lane, Down Hatherley, Gloucester, Gloucestershire
Approximate Gross Internal Area
235 Sq M/2529 Sq Ft

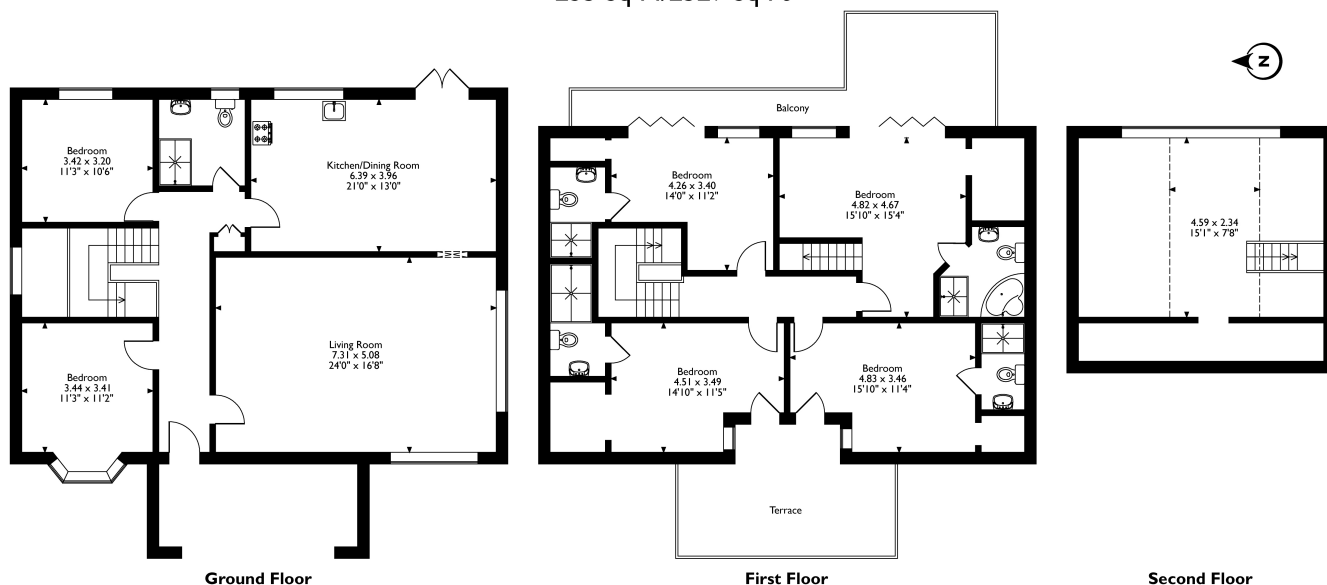

Please note that the location of doors, windows and other items are approximate and this floorplan is to be used for illustrative purposes only. Unauthorized reproduction is prohibited.

Energy Efficiency Rating		
	Current	Potential
Very energy efficient - lower running costs		
(92+) A		
(81-91) B		
(69-80) C		
(55-68) D	66	71
(39-54) E		
(21-38) F		
(1-20) G		
Not energy efficient - higher running costs		
England, Scotland & Wales		
EU Directive 2002/91/EC		



20-22 Bridge End, Leeds, LS1 4DJ
t: 0330 004 0050 e: hello@bettermove.co.uk
www.bettermove.co.uk

Please Note: These particulars, whilst believed to be accurate are set out as a general outline only for guidance and do not constitute any part of an offer or contract. Intending purchasers should not rely on them as statements of representations of fact, but must satisfy themselves by inspection or otherwise as to their accuracy. No person in this firm's employment has the authority to make or give any representation or warranty in respect of the property.